

# BREAKFAST POLICY

- *Beyond The Wall Bed and Breakfast LLC may most likely be referred to as "Beyond The Wall" ... "BTW" ... or "B&B" on its website, Facebook Page, verbally over the phone or on premise. In any document originating from its website, Facebook Page or from on premise, or verbally over phone or on premise, these abbreviations and acronyms are to be considered the entity Beyond The Wall Bed and Breakfast LLC*
- *As with all policies, ours are subject to modification at any time. If you have any questions regarding this policy, please ask for clarification or to ensure that you have the most accurate and up to date pertaining information*

- *Apologies, We Do Not Accept Reservations For Breakfast*
- *We Follow a "First Come, First Serve" Seating Policy*
- *By Request (Reasonable Notice Please), We Can Serve Your Group "Family Style" ... Basically Pushing Tables Together And Then Bringing Food Out On Platters, Bowls And Each Person Serves Themselves Like At Home*
- *In Order To Preserve The Cherished Vibe Here, We Cook And Serve At A Pace That Your Friends And Family Would. Absolutely We'll Always Try To Keep It A Bit "Snappy" But Crazy Never Needs To Occur At Our Breakfasts. That Stress Lingers For Hours Here ... A Shower Won't Even Take It Off, And Nobody Wants To Feel It*

## HOURS

- **TYPICAL: 0900 to 1030 (Typical = 99.9% Of The Time)**
- **EXCEPTIONS: May Occur, Relax ... Most of You Are On Vacation (If Not, PRETEND)**
  - **EXCEPTIONS - RARE On Weekends And From January To June (See Graphic Below)**
- **We Can Serve Earlier, If Needed ..... By Request .... For Reasonable Reasons**
  - **REASONABLE REASONS That Have Happened Since May 2017**
    - **0830 – Guest Staying Multiple Nights, Business Meetings Start At 0900**
    - **0830 – Guests Stayed Multiple Nights, Have A Flight At 1100**
    - **0815 – Guests Part Of Corporate Account, Early Breakfast Negotiated Prior**
    - **0830 – Guests Have Specialized Medical Appointments**
- **EARLY RISERS? See "Breakfast To Go" Below**
- **It's That Way And Well ... You Have A Fridge In Your Room, Please Plan Accordingly. Granola Bar, BABY ... Until We Get The Griddle All Heated Up For Everyone At 0900**
- **NOTE: Any Place You Can Book A Room Here, Direct Or With Any Online Travel Agency (Booking.com, Expedia, Hotels.com ...blah, blah, blah) We Have Clearly, Intentionally Stated That Our Breakfast Starts At 0900. Again, You Complaining On Your Review That Our Breakfast Doesn't Start Until 0900 Just Makes You Look Like A Big Poopy Face, Dumb Dumb Head !!!**

- **COMPETITION (All Within Walking Distance Of BTW)**
  - **Place One – Breakfast An ADDITIONAL Fee, Menu (“Starting” at \$15 each)**
    - **Breakfast Hours 0700-1100**
  - **Place Two – Breakfast Free (Buffet) Mmmm, Truck Stop Mmmm**
    - **Breakfast Hours 0630-1030**
  - **Place Three – Breakfast Free (Buffet) Mmmm, Truck Stop Mmmm**
    - **Breakfast Hours 0700-1000**
  - **Place Four – Breakfast An ADDITIONAL Fee, Menu (“Starting” at \$12 each)**
    - **Breakfast Hours 0900-1100**

**MAIN REASON FOR BREAKFAST HOURS ...**

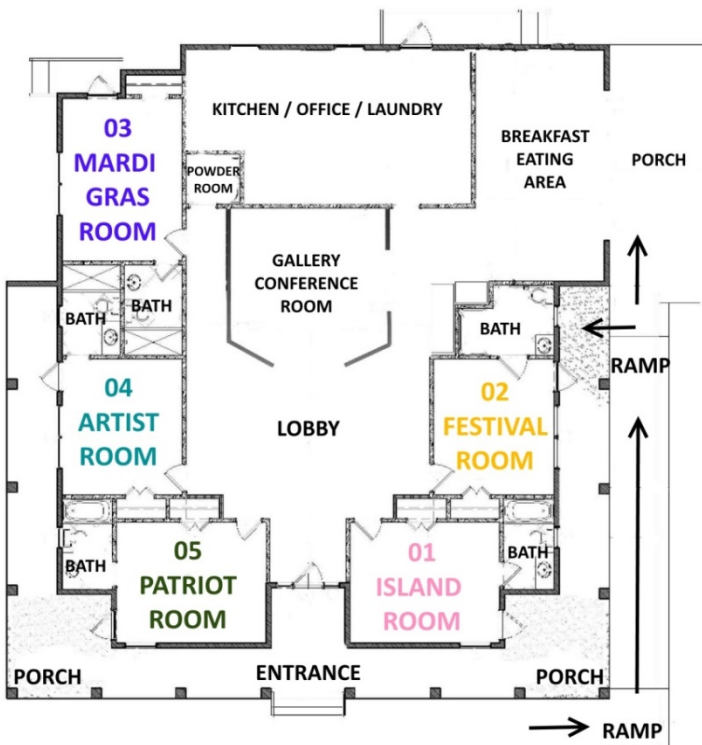

**... Because Of Potential Noise**

We Simply Want Our Guests To Relax And Sleep Comfortably. Sure, You Might Be An Early Riser But In The Years We’ve Done This, Undisputed ... Easily 90+% Of Folks LOVE The Breakfast Hours, Sleeping In And Not Having To Deal With The Noises Associated With Folks Bouncing Around The Common Areas Before 0900

No One Needs To Ever Get Upset For THREE BIG Reasons. FIRST ... You Have Choices (See Above). SECOND ...

Full Disclosure, You Were Informed Of Our Breakfast Hours Before You Booked. And Finally, And Most Importantly ... You May Be That 1 Out Of 100 Persons That Doesn’t Dig How And When We Do Breakfast, BUT **We Promise To Delight You In Hundreds Of Other Ways ...** Or Smile And Wave As You Leave To Stay Somewhere Else. No One Has To Ever Get Upset, Go Do What You Need To Do At A Place With The Perfect Breakfast Hours For You

- **VISITORS** – Of guests ... Guests having visitors have breakfast with them
  - We must ask that visitors of our guests pay a simple \$12 + current tax rate fee, per person for their breakfast
    - The fee may change at any time for many reasons, but it'll be in that range
- **ANIMALS** – With the exception of authorized service animals, animals are NOT allowed in the Main House. This includes our eating area
  - Dogs may accompany you on the back porch, if and after you should decide to carry your food out to the back porch
  - Please use the exterior access to the porch (*ramp*), to get your dog on to the porch
- **BREAKFAST MENU** – The menu is posted on the Menu Board as you enter the dining area each morning. We are not a full-service restaurant and guests are required to select from the Menu Board. A La Carte choices are available at the bottom of the menu for those guests who are not able to enjoy the entrée choices. This is what is included in your room/cottage rate. If you must deviate from the menu as presented, 1 entrée and a side of your choice, we MAY be able to accommodate. An additional fee of \$12 plus the current tax will apply
- **ALLERGIES** - We cannot guarantee that food allergies or other food related health concerns will not be an issue as we will be cooking and storing a variety of foods all within the same kitchen space
- **BUTTER** – A LOT, We Use Real Butter ..... We Love Real Butter. Always 100% REAL Butter
- **PORK** - We LOVE pork products ..... BACON, Sausage ... Pork, Pork, Pork. We're happy to serve you a portion of either bacon or sausage every single, glorious PORK day. "Here Piggy Piggy"
- **FRESH** - We generally produce meals from fresh ingredients if you join us in the dining area. We don't prepare freezer food in the microwave and call that a hot meal
  - NEVER BUFFET (*Truck Stop, Chain Hotel, Screaming Kids Style*)
    - 10-4 Good Buddy, Mercy Sakes Alive ... I Think We Got Ourselves A Convoy
  - NO TIMMYs
    - TIMMY !!! Don't Touch That. TIMMY !!! Put That Down. TIMMY !!!
    - TIMMY !!! Eat Your Breakfast. TIMMY !!! Chew With Your Mouth Closed. TIMMY !!!
    - TIMMY !!! Get Back In Your Seat. TIMMY !!! No More Donuts. TIMMY !!!
  - NEVER POWDERED EGGS
  - NEVER PANCAKES FROM A MACHINE
  - NEVER HOSTESS PRODUCTS – Or anything you have to tear open plastic wrap with your teeth. YUCK
    - *Remember the lunch lady with scissors that would cut that open for you?*

- **BREAKFAST IN BED / ROOM SERVICE** – Can be coordinated the day prior by 1800 but will include additional charges. The more fun you make it, the less it will probably cost you (not kidding). The standard breakfast hours apply for this service
- **BREAKFAST “TO GO”** - For those heading out early or those wanting to sleep in as long as the request is made prior to 1800 the day prior. Contents of the “To Go” offering will be at the discretion of the owners and fresh made meals are generally only available in the dining area during regular service hours. Food safety is the responsibility of the guest requesting this service. BTW cannot be held responsible if the food is not refrigerated and reheated appropriately
- **COFFEE** - Both caffeinated and decaffeinated, will be available mornings, located in the eating area
  - Coffee typically ready between 0800-0830, mostly, maybe ....good chance
- **TEAS** - Both caffeinated and decaffeinated, will be available mornings, located in the eating area
  - Also, mostly, maybe ....good chance
- **ICE MACHINE / WATER** – Available during the day at the Ice Machine, located in the eating area of the Main House
  - Cottage Guests have access to this ice from breakfast hours until generally 2200 each night. Please plan accordingly as for security reasons ....we lock the front door to our Main Building regardless of the time of day if we are not able to directly monitor the house
  - For hundreds of reasons, the front door may be locked to our Main Building during the day. Obtaining Ice / Water from our Ice Machine may not be possible at times
  - APOLOGIES: Relax ..... Be Flexible, Most of You Are On Vacation (If not, pretend)
  - **ICE MACHINE is not provided for, designed for or capable of filling coolers**
    - ***PLEASE DO NOT FILL COOLERS OR LARGE CONTAINERS WITH OUR ICE***
- **HOT BEVERAGES** – Will be from the start of breakfast hours until about noon each day. Maybe, maybe not ...but it’s what we try to accomplish
- **BREAKFAST CHOICES** – Will be advertised daily on our menu board in the indoor eating area as they will change pending the season and our mood. For those interested in a cold breakfast, limited choices will be made available generally consisting of fresh fruit, yogurt and muffins
- **ALLERGIES AND DIETARY RESTRICTIONS** – We understand some guests may have ALLERGIES and special dietary restrictions. Please note these ALLERGIES and restrictions on your Check in Appointment Form. We try to have choices to cover all the known dietary restrictions if we have at least 3 days advance notice. We do not guarantee that all ALLERGIES can be 100% avoided and / or that all dietary restrictions can be accommodated